

DESCRIPTION OF BOAT LIFT FOR TRAILER-BOAT

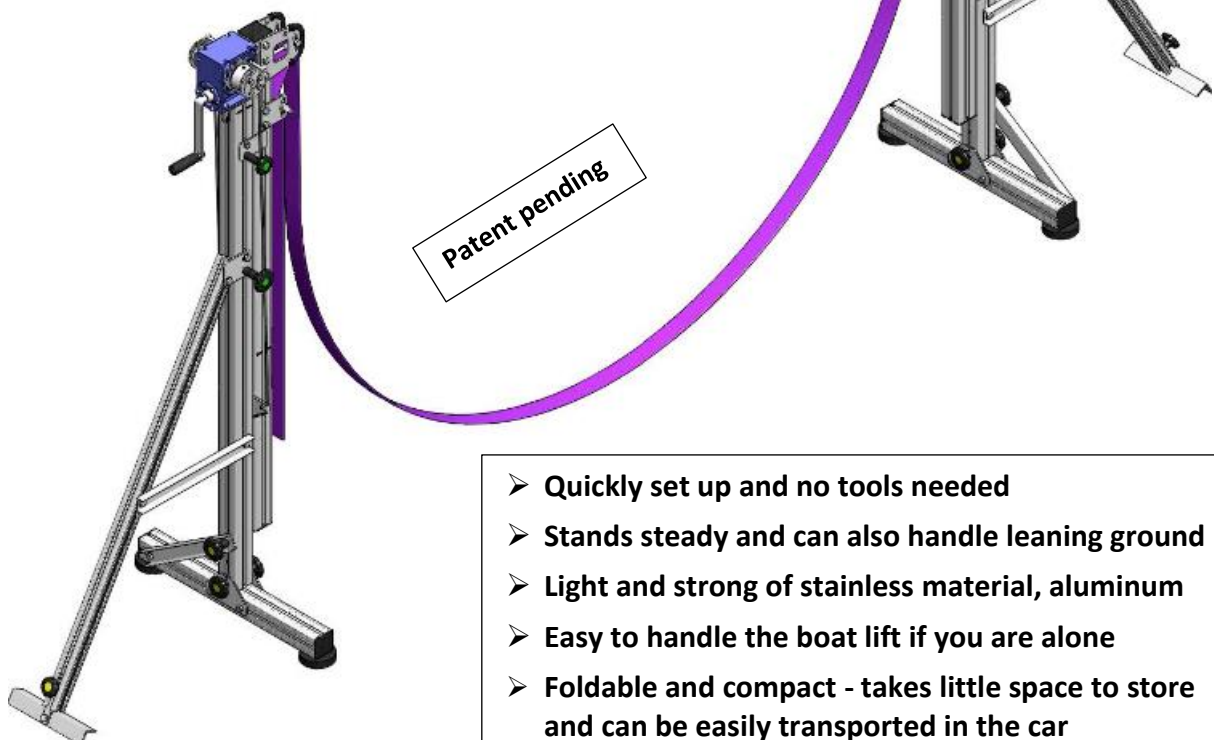

A new unique boat lift for loading and unloading of boats on trailer consists of two foldable lifting units, one on each side of the boat lifted with a strap so that a boat trailer can be rolled in or out under the boat when launching or when the boat comes up on land. Boat stands or a trestle beneath the boat's stern are necessary for loading or unloading. The boat is lifted or lowered when rotating the hand crank on the respective lifting device.

- **Instead of having a boat trailer as while the boat is in the water occupy a large place on land you can rent or borrow a trailer and with help of the Boat lift put the boat on trestles or boat stands - cheaper and better in several ways**
- **No rolls and frame in the way - easier to work with washing, grinding and painting under the boat**
- **Divide the lift with someone - half the cost of the lift and no investment in a boat trailer**



- **Quickly set up and no tools needed**
- **Stands steady and can also handle leaning ground**
- **Light and strong of stainless material, aluminum**
- **Easy to handle the boat lift if you are alone**
- **Foldable and compact - takes little space to store and can be easily transported in the car**



1. The boat start to be lifted for loading on a boat trailer

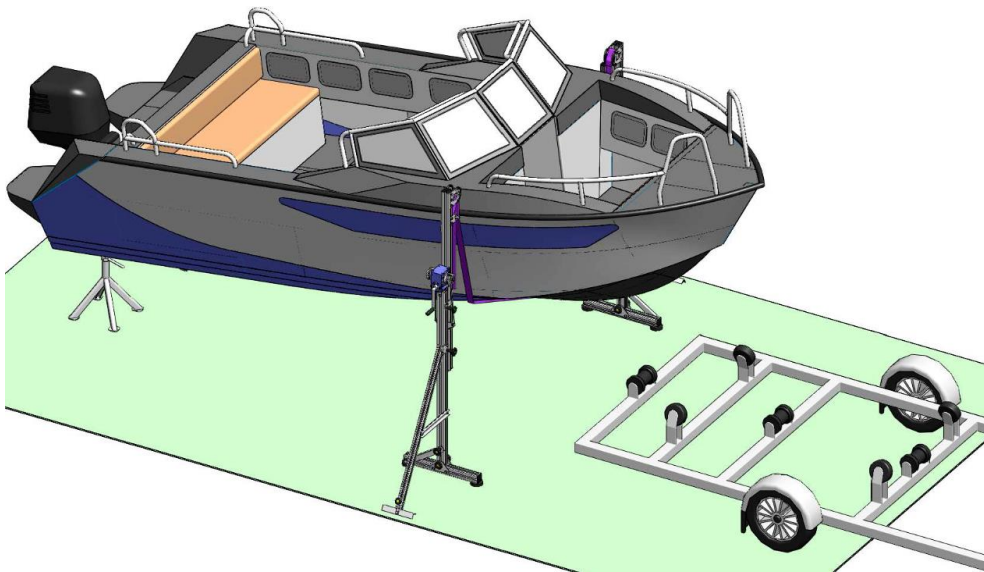

2. The boat front in the raised position and the trailer being rolled in below the boat



3. The trailer is below the boat and the boat's front has been lowered. The supports under the stern and the boat lift can now be removed



Main parts:

1. Foot
2. Fixed tube
3. Lifting tube
4. Side support that can be folded in
5. Side support bracket + quick-knob
6. Supporting the ground, pivotable
7. Upper bracket/lock for the belt
8. Lower lock for the belt
9. Support against the boat
10. Worm gear, self-locking
11. Crank
12. Wire
13. Wire-wheel, 2 pieces
14. Locking of tube (3) during transport

– The boat lift is compact and lightweight (about 95% aluminum) so it can be easily lifted and used by only one person.

– The boat lift is quick to fold (left picture) and even the crank (11) can easily be removed. This makes it easy to transport for a normal car and occupy a small place when stored. If you need to reduce the size further, the foot (1) and side support against the ground (6) can easily be removed.

– The lift is placed vertically against the side of the boat. If the ground is tilted in the transverse direction of the boat, adjustment to vertical position can be done quickly by lowering or raising the side support upper bracket with the quick-knob (5).

– If the ground is tilted in the longitudinal direction of the boat, the foot (1) can be tilted by standing on it, grabbing the upper part of the boat lift and turning it until the lift is vertical.

- The side support angle to the ground (6), which is also pivotable, also turns, that is, adapting to the slope of the ground.

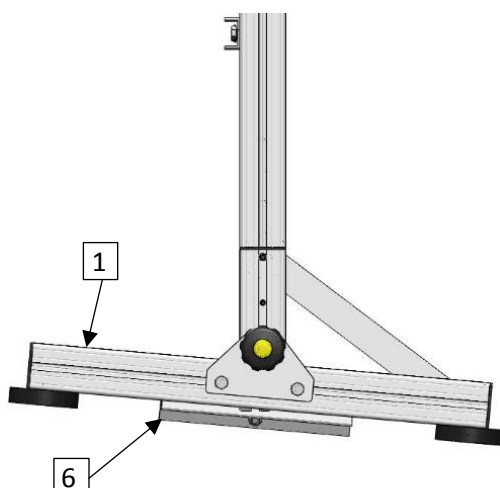

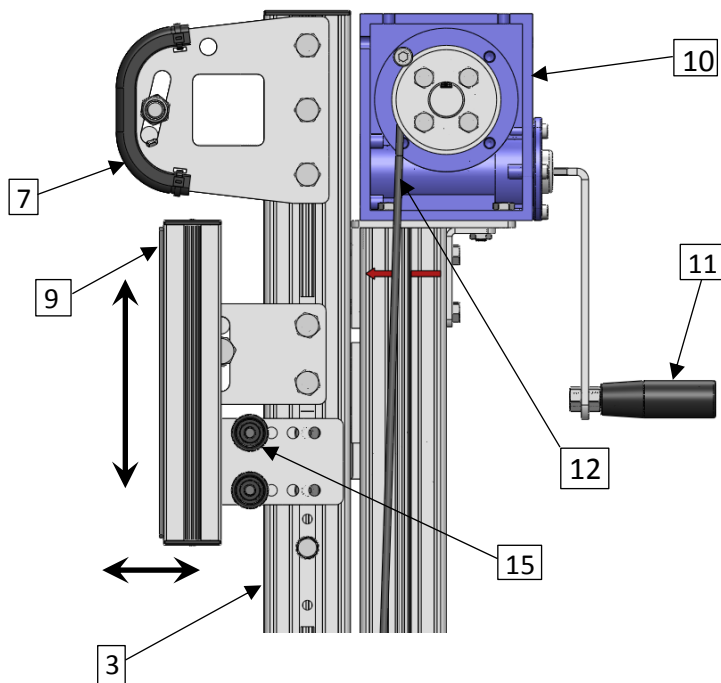

– The worm-gear (10) has high gear and is self-locking so it cannot rotate when releasing the crank (11).

– The wire (12) lifts the left tube (3) about 4 mm per turn as the crank (11) being rotated.

– The support (9) against the boat can be moved out against the boat's edge with the knob wheels (15) so that the upper bracket (7) is held out from the boat if it has a pulpit just above the rim/edge. Normally the support (9) is in its innermost position as shown in the picture. The support (9) can easily be moved vertically by pulling it, downwards when loading or unloading the belt or if the boat is very low.

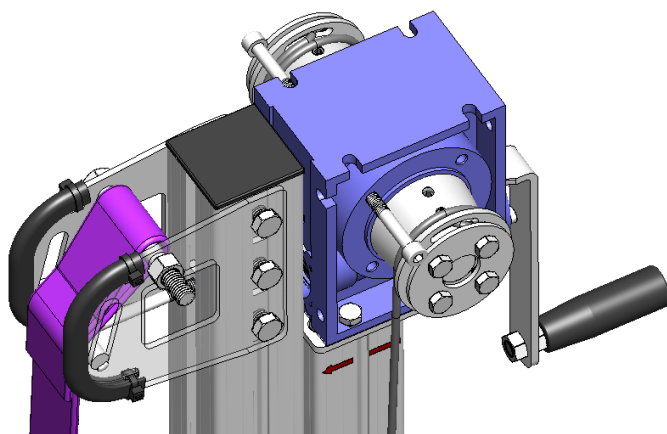

Assembling the belt. Lift A:

On one of the lifting devices (which lacks the belt tensioner), the belt is attached with an bolt trough the top of the belt's loop. See the picture beside.

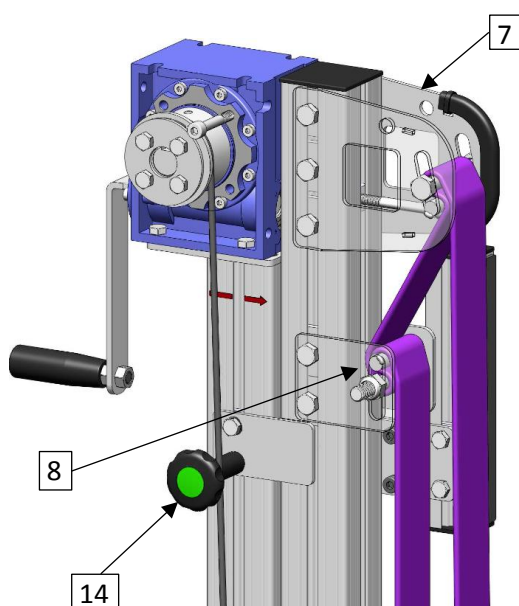

Assembling the belt. Lift B:

The other lifting device can pre-tension the belt via two self-locking belt tensioners.

The right-hand part of the belt (see picture) coming from the boat is first pulled through the upper belt tensioner (7) as shown and then stretched from the boat by hand.

Then pull the belt through the lower belt tensioner as shown. Then it is clear to lift the boat.

The quick-knob (14) is used to lock the movable tube (3) during transport or when carrying / moving the lift.

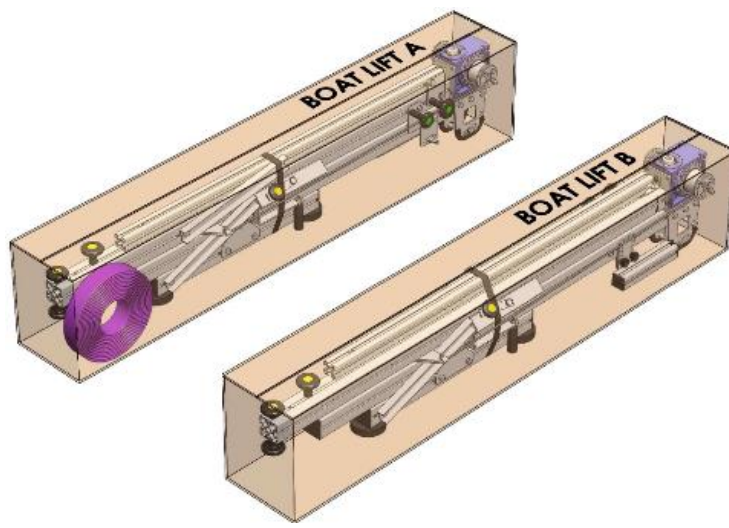

– The boat lift is delivered in two equal cartons, A + B with dimensions 1640 x 230 x 325 mm. Weight about 24 kg / carton.

– Only the foot and side support part (6) and two turning knobs needs to be assembled, which only takes about 5-10 minutes and no tools are needed.

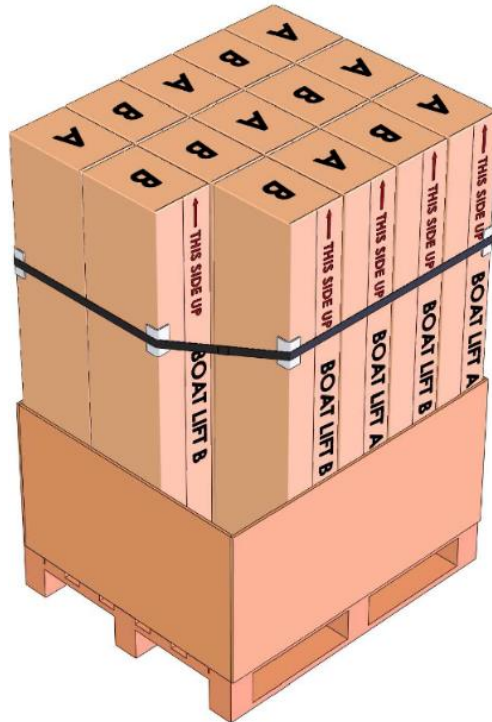

– Each pallet contains 14 packages, i.e. 7 complete boat lifts.

Technical data:

Weight complete assembled	23 + 23 kg
Total length, with foot / without foot	1670 / 1590 mm
Lifting height	Approx. 450 – 700 mm
Max lifting weight / weight boat	1,5 ton / 2,5 ton
Lifting belt	Approved for U-lift of 2 ton. 7 x safety. In accordance with EN 1492
Lifting wire	Approved for U-lift of 3,5 ton. 5 x safety. In accordance with EN 12385
Approved	CE

Designed by:

GL-Tech in Sweden. Phone: +46 (0)708 837 469. E-mail: gl-tech@telia.com